

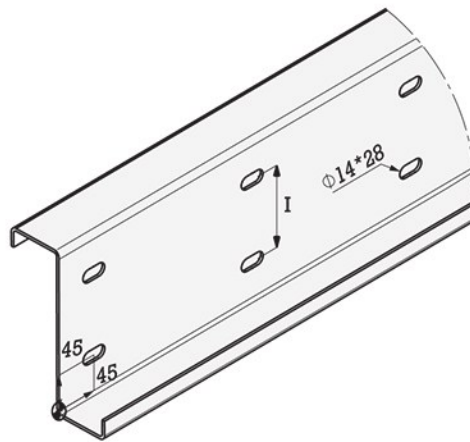

● Z-Purlin

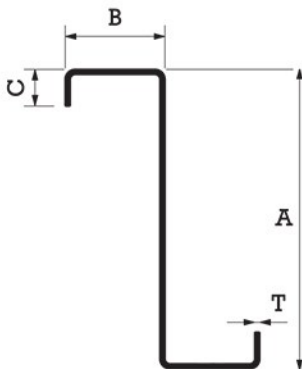
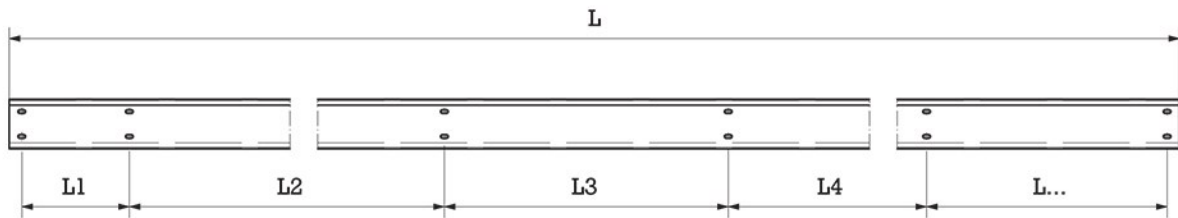

Z-Purlin							
A	B	C	I	L1, L2,...	Weight (Kg/m) : $\pm 4\%$		
					T=2	T=2.5	T=3
160	60	22	70	≥ 90	4.61	5.88	6.94
180	60	22	90	≥ 90	4.92	6.27	7.41
200	60	22	110	≥ 90	5.23	6.67	7.88
220	60	22	130	≥ 90	5.55	7.06	8.36

Dimensions (mm)



● Z-Purlin

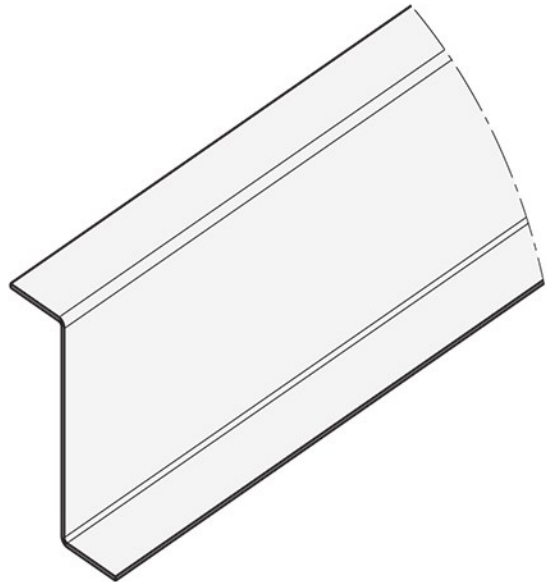
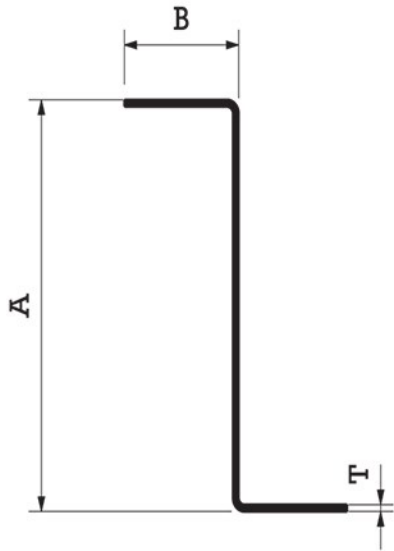

Z-Purlin	
A	B
160	60
180	60
200	60
220	60
T = 2, 2.5, 3	

Dimensions (mm)



● C-Purlin

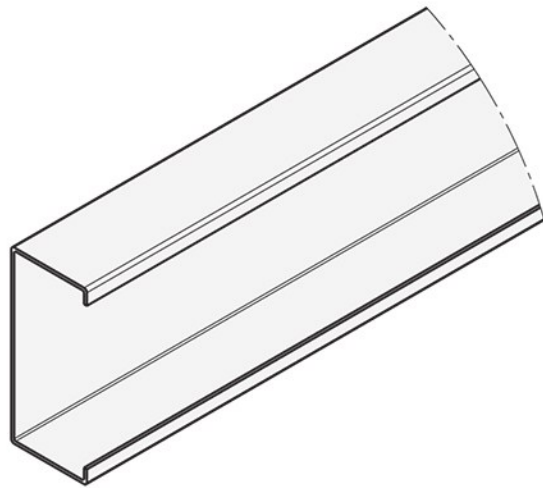
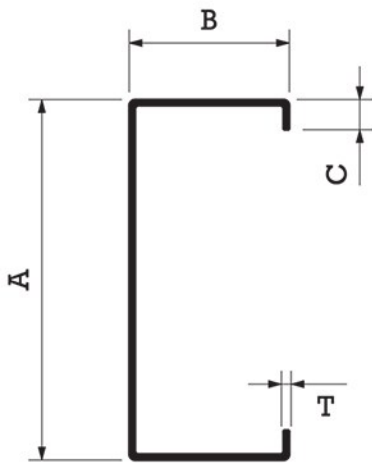

C-Purlin		
A	B	C
160	60	30
180	60	30
200	60	30
220	60	30
T = 2, 2.5, 3		

Dimensions (mm)



● Purlin Cleat

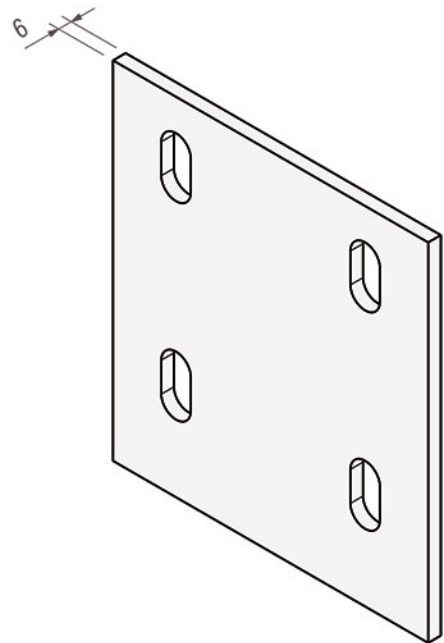
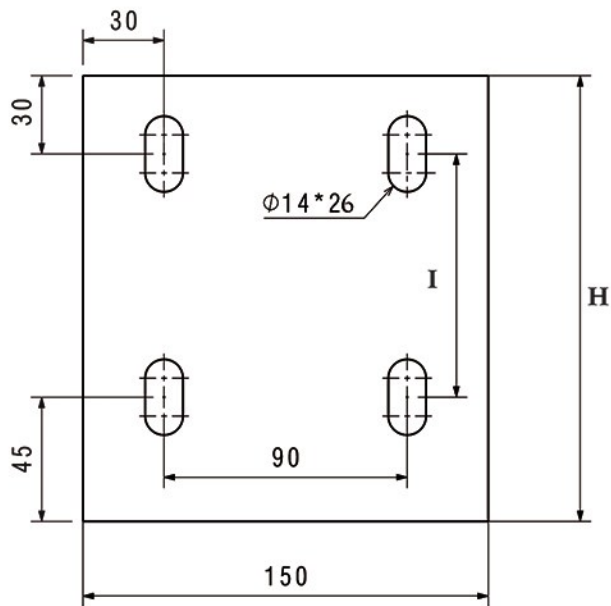

Purlin Cleat	
I	H
70	145
90	165
110	185
130	205

Dimensions (mm)



● Gutter

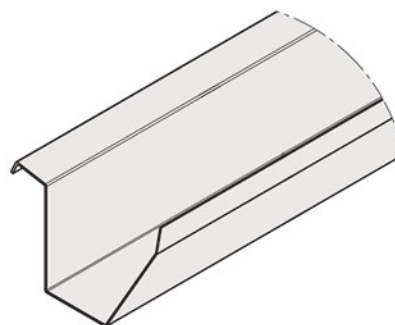
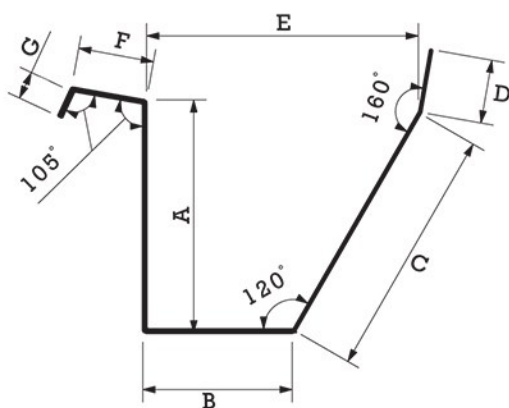

Gutter						
A	B	C	D	E	F	G
160	120	185	40-60	210	60	25-40
180	120	210	40-60	215	60	25-40
200	120	230	40-60	232	60	25-40
220	120	255	40-60	245	60	25-40

Dimensions (mm)



● Gutter (Double-Sided)

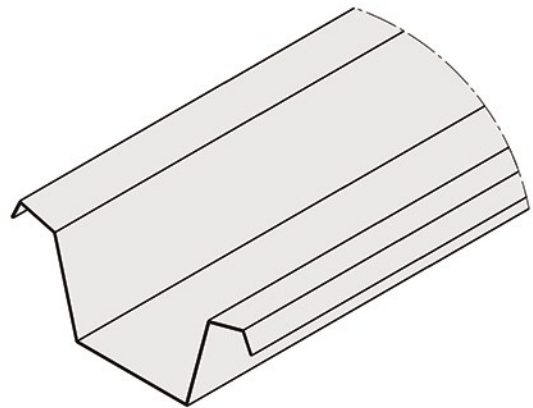
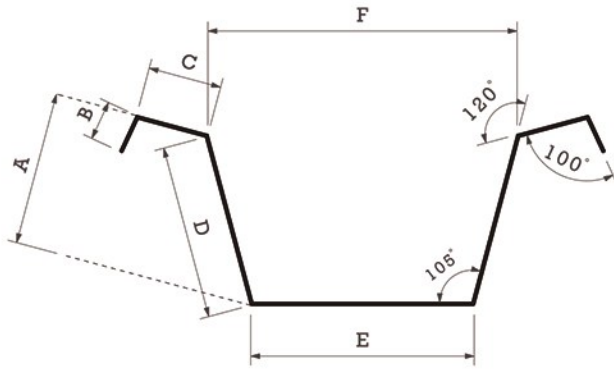

Gutter (Double-Sided)					
A	B	C	D	E	F
160	25-40	60	167	240	327
180	25-40	60	187	240	337
200	25-40	60	207	240	347
220	25-40	60	227	240	357

Dimensions (mm)

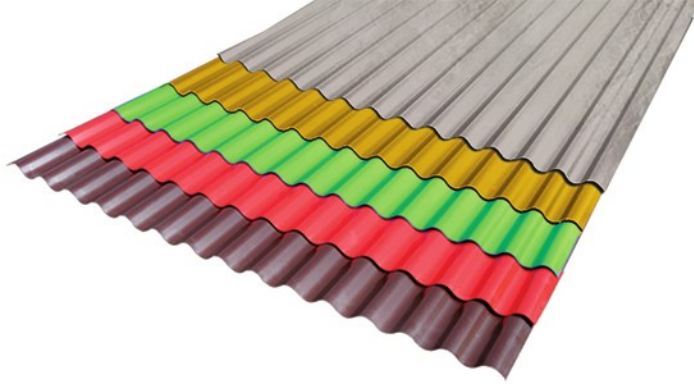

● **Sinusoidal (Color Coated/Galvanized)**

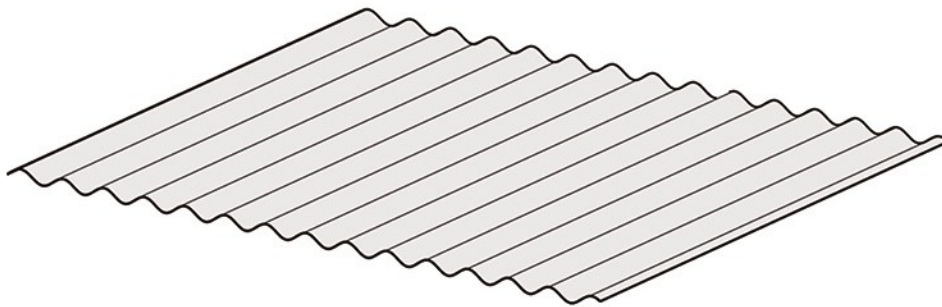
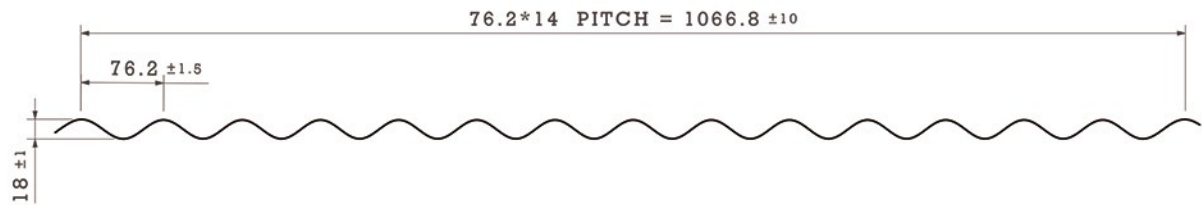

Sinusoidal(Color Coated/Galvanized)

Thickness	0.4	0.5	0.6
Weight (kg/m)	3.9	4.88	5.85

Dimensions (mm)

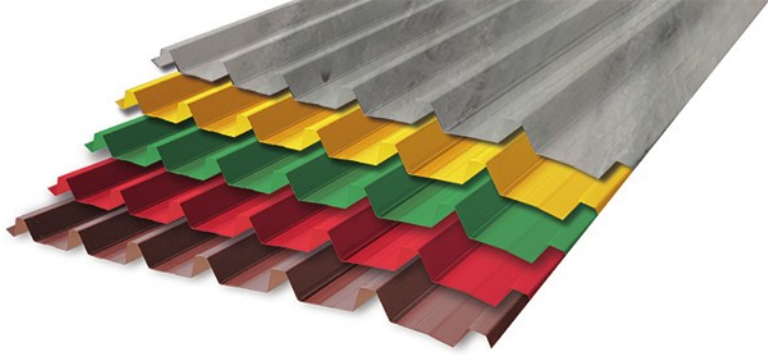

● **Shadow-Line (Color Coated/Galvanized)**

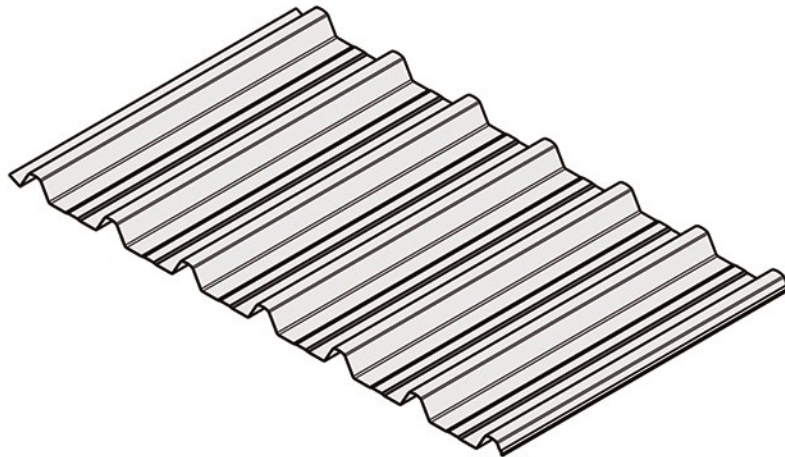
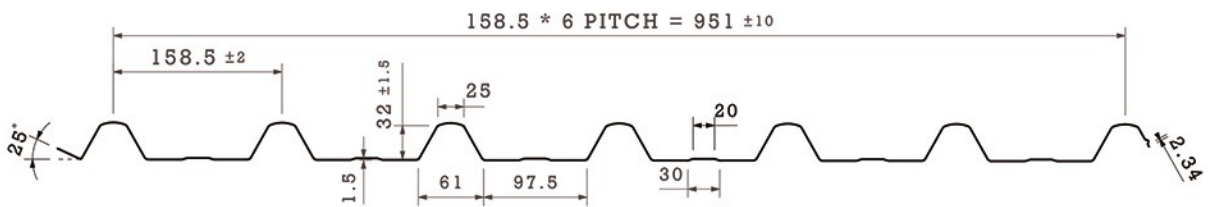

Shadow-Line (Color Coated/Galvanized)			
Thickness	0.4	0.5	0.6
Weight (kg/m)	3.9	4.88	5.85

Dimensions (mm)



● Door/Window Frame

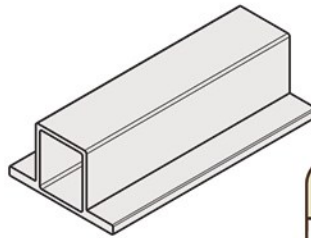
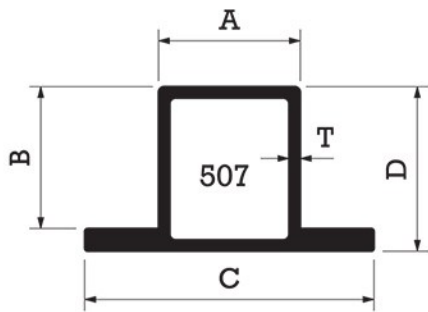

507					
Dimension (mm)			Weight (kg/m)		
A	B	C	D	T=2	T=2.5
25	25	51	29	2.44	3.05

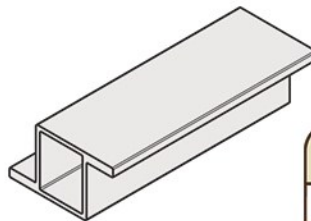
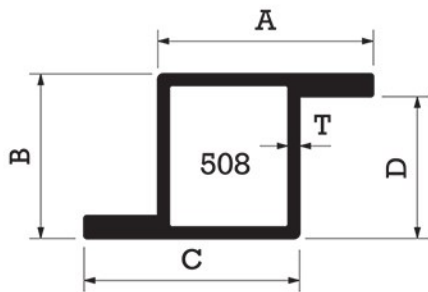

508					
Dimension (mm)			Weight (kg/m)		
A	B	C	D	T=2	T=2.5
38	29	38	25	2.44	3.05

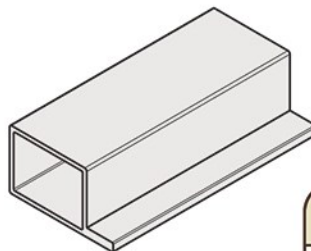
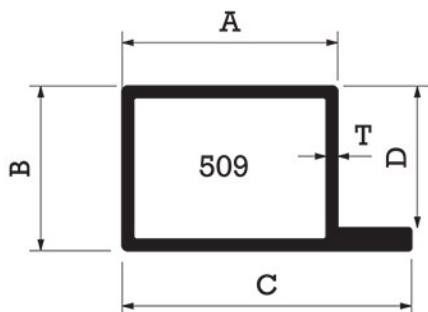

509					
Dimension (mm)			Weight (kg/m)		
A	B	C	D	T=2	T=2.5
38	29	51	25	2.44	3.05



● Square/Rectungular Tube

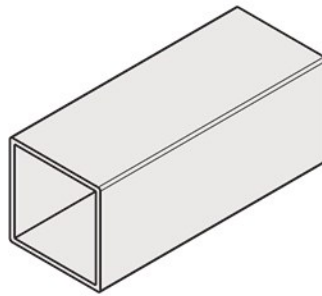
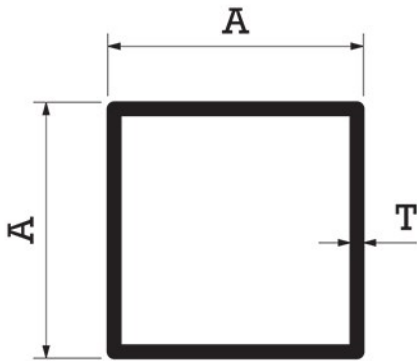

Square Tubes			
Dimension (mm)	Weight (kg/m)		
A	T=2	T=2.5	T=3
40	2.44	3.05
90	6.95	8.34

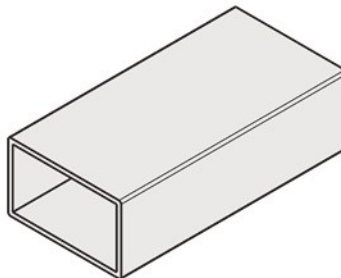
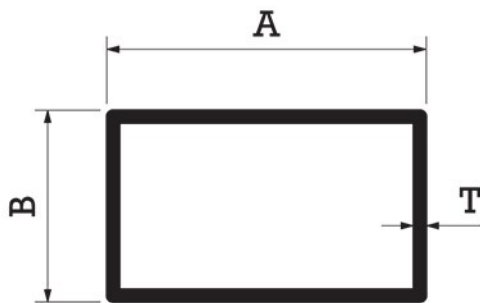

Rectangular Tubes			
Dimension (mm)		Weight (kg/m)	
A	B	T=2	T=2.5
50	30	2.44	3.05
80	40	3.68	4.6



● Road Guardrail (Conform to IRAN Standard)

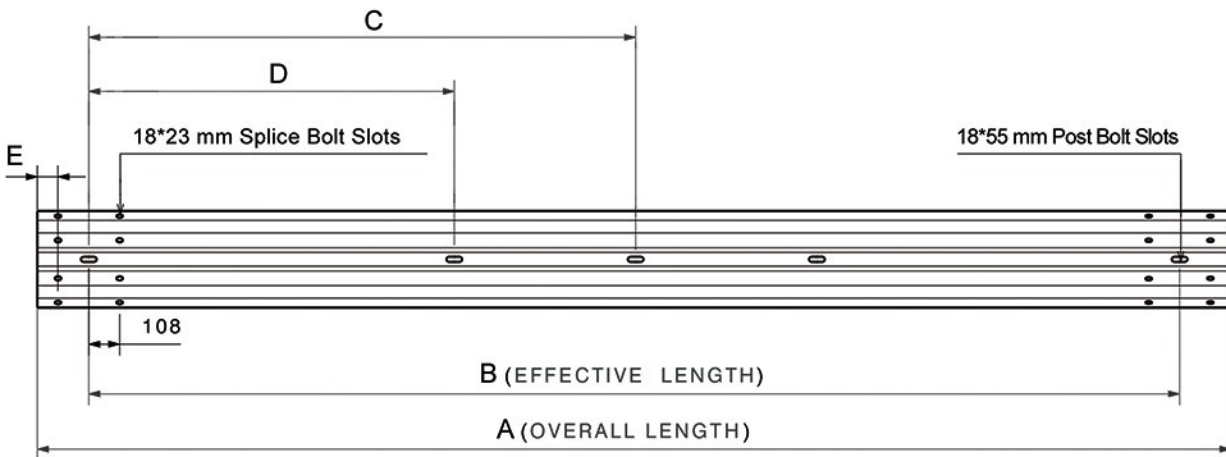
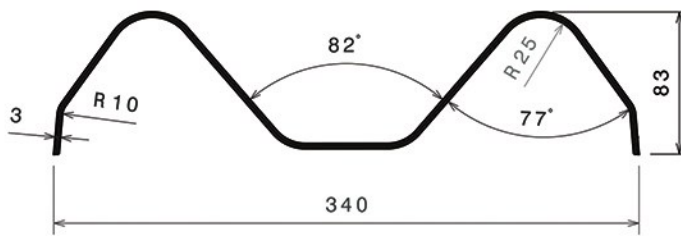

*Dimension (mm)	A	B	C	D	E
Standard					
Type 1	4170	3810	1905	1270	72
Type 2	4200	3900	1950	1300	42

* Special Dimensions Available Upon Request



● Road Guardrail (Conform to AASHTO* M 180 Requirements)

● W-Beam

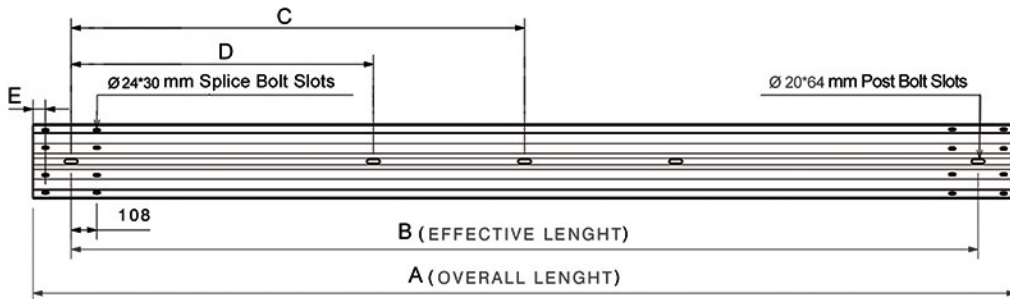
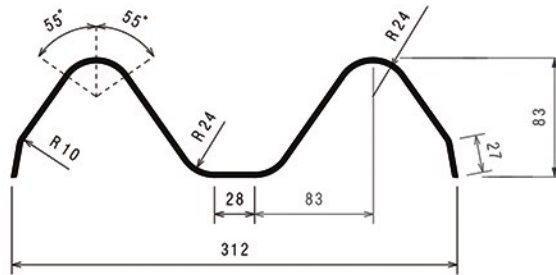

● Thrie-Beam

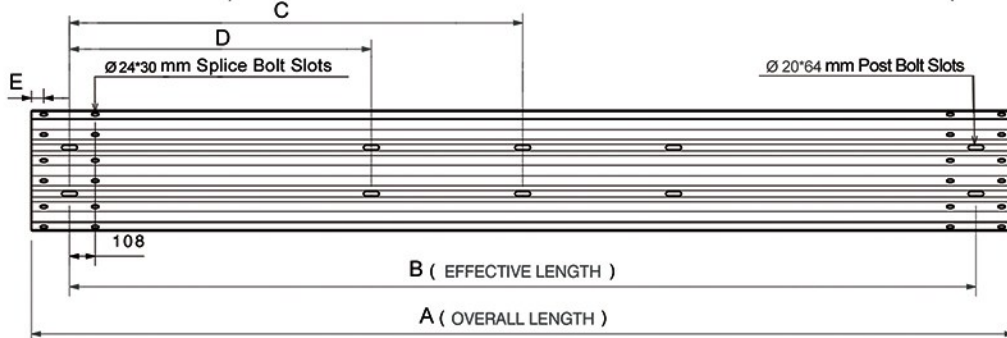
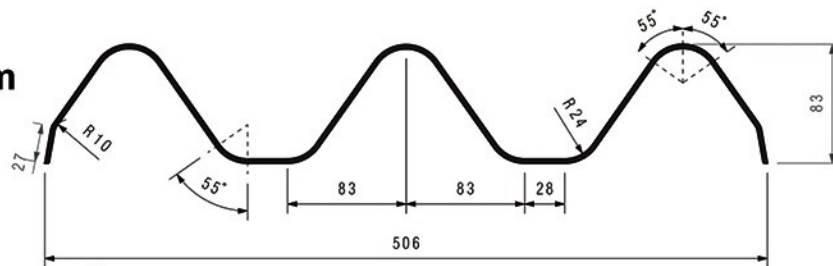

Dimension **	A	B	C	D	E
Length (mm)	4130	3810	1905	1270	52

* AASHTO: American Association of State Highway and Transportation Officials

** Special Dimensions Available Upon Request

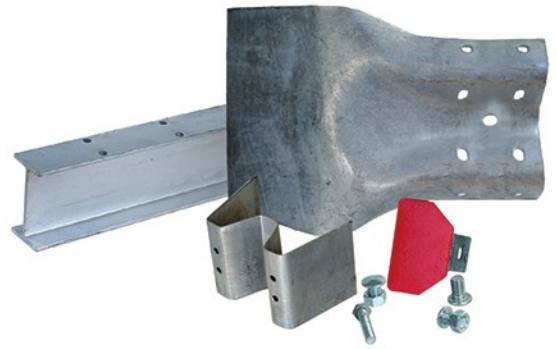

● Guardrail Post

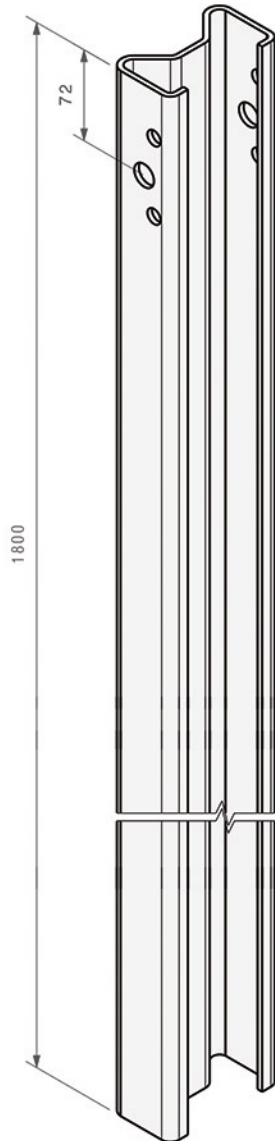
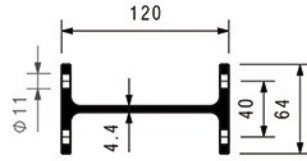
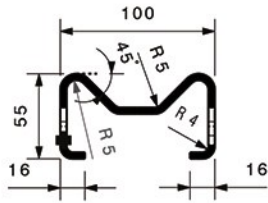

● Sigma Post

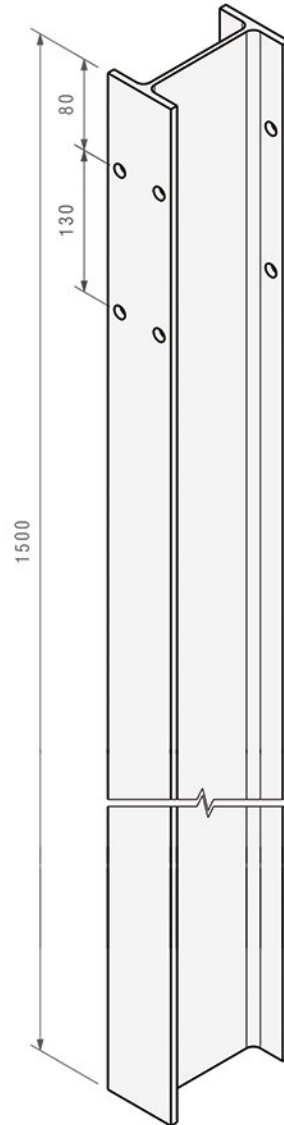

● IPE Post

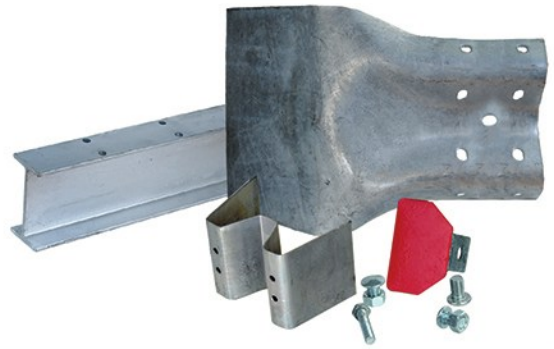

● Guardrail Post

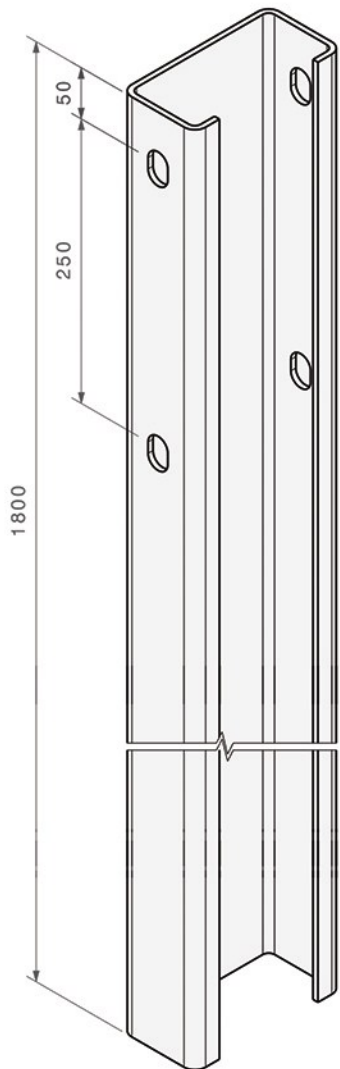
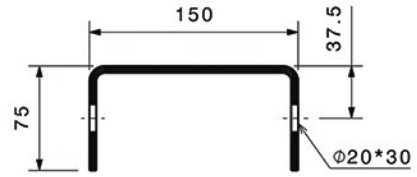
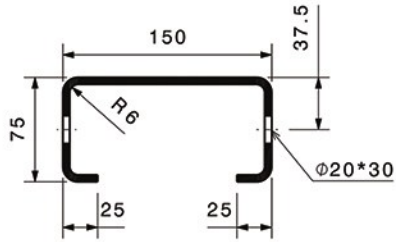

● C-Post

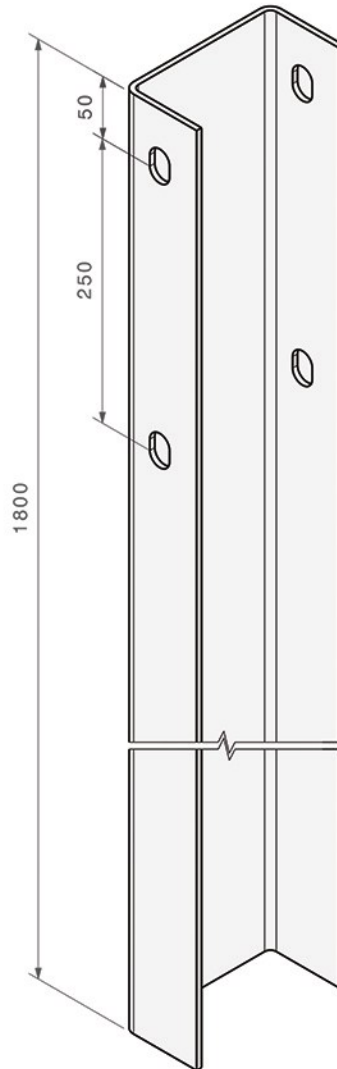

● U-Post

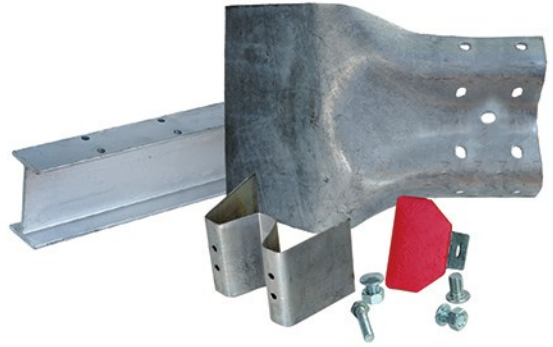

● Guardrail Accessories

● Post Clamp

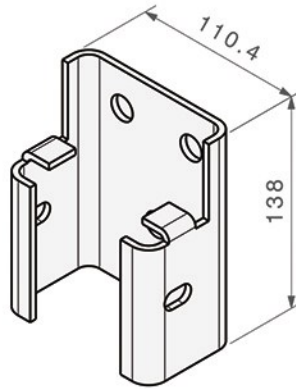

● Spacer

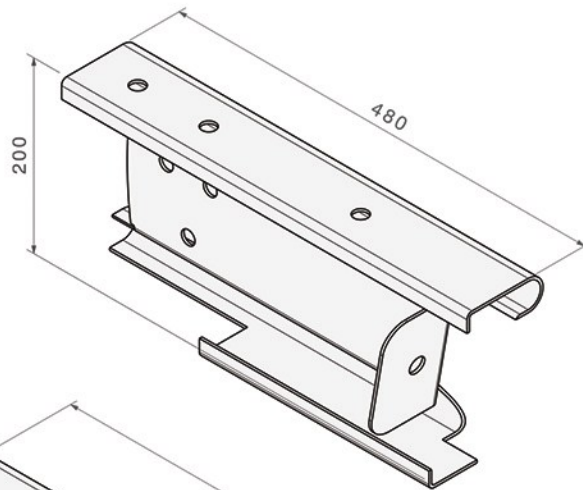

● Spacer (Double-Sided)

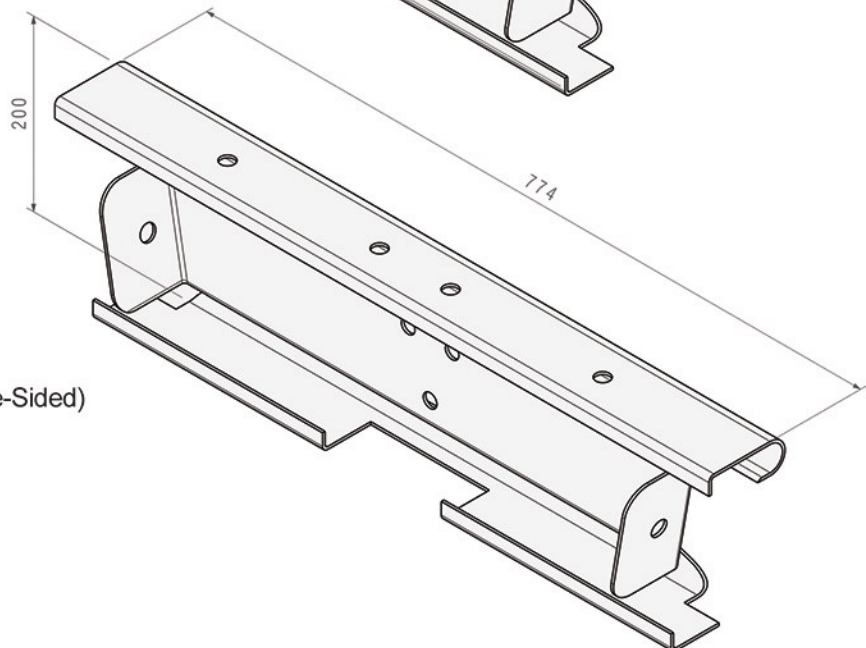

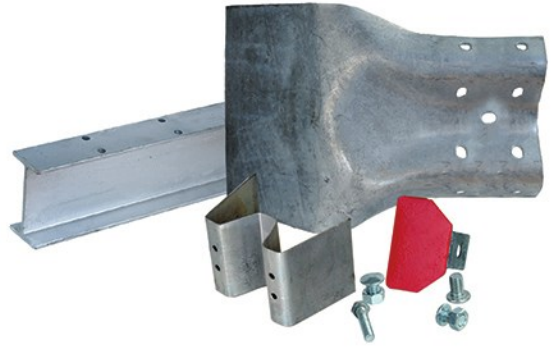

● **Guardrail Accessories**

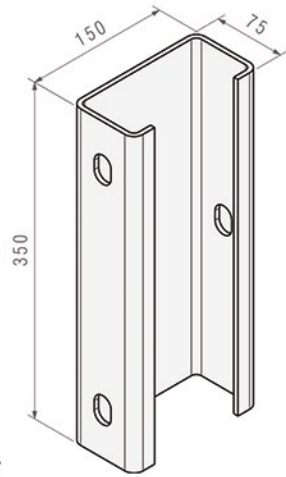

● C-spacer

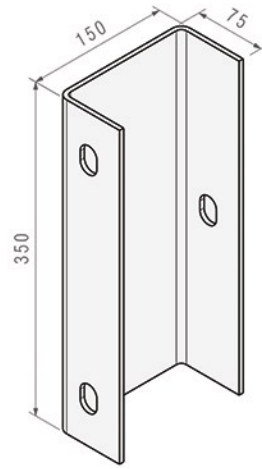

● U-spacer

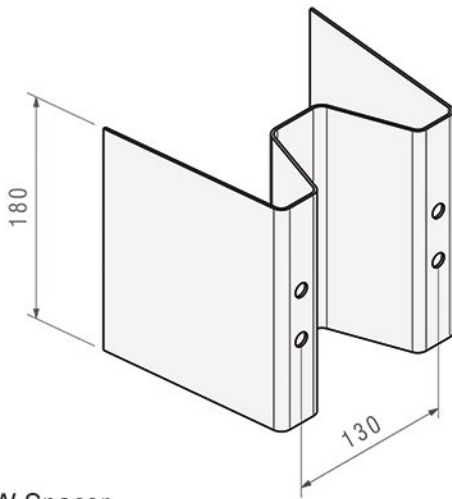

● W-spacer

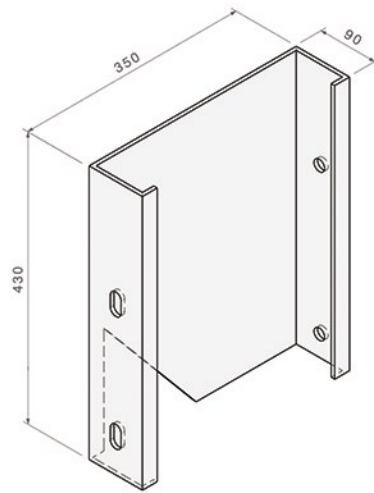

● Thrie-Beam Spacer

● Terminal Section

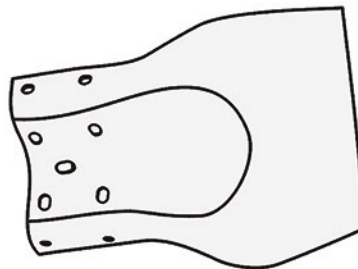

● Installation (According to EN 1317*)

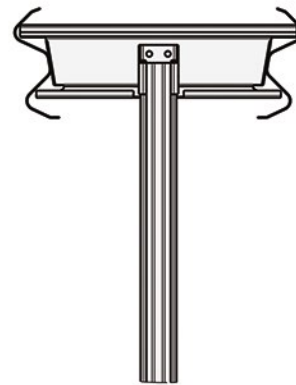
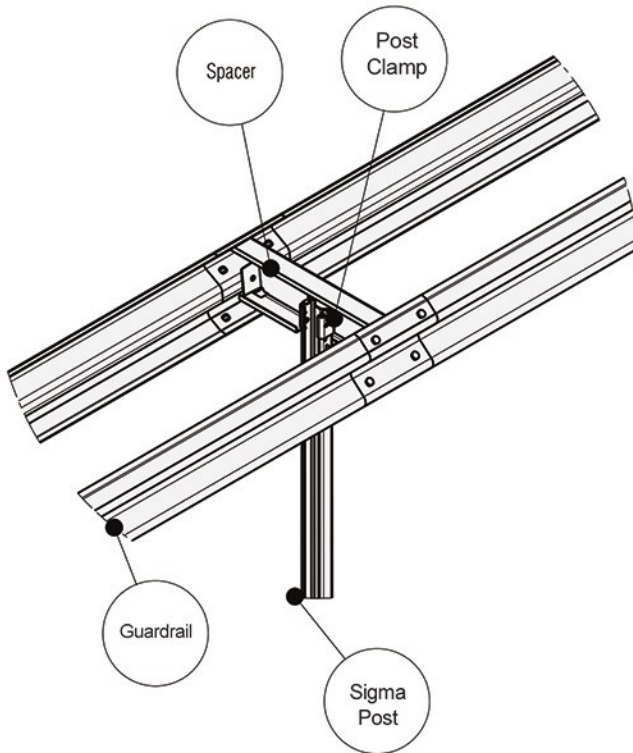
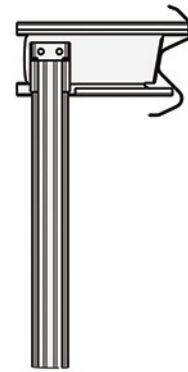
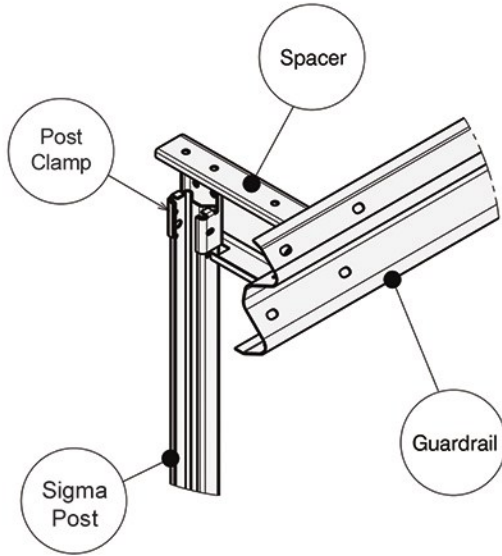

* EN 1317 is a European Norm established in 1998 that defines common testing and certification procedures for road restraint systems.

● Installation

